



**PACESETTER  
HOMES**

A QUALICO<sup>®</sup> Company

# AVIATOR

---

- **Bedroom: 3**
  - **Bathroom: 2**
- 

**Main Floor: 1590 SQ.FT.**

**Total: 1590 SQ.FT.**

---



# AVIATOR

## Home Features:

- Bungalow
- Open Concept Layout
- Attached Double Garage for Added Convenience
- Full Basement with Optional Development Opportunities
- 1-2-5-10 New Home Warranty Protection.

The **AVIATOR**  
 5601 Parliament Avenue  
 3 Bedrooms, WIC, Double Garage  
 Total 1590 SF.  
 Units: 4\*, 11, 12\*, 14\*, 16\*, 17, 19, 20\*, 22\*, 23 & 30\*  
 \*Reverse units

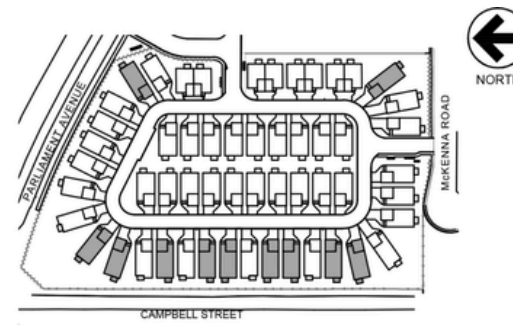

MAIN FLOOR



LOWER LEVEL - OPTIONAL DEVELOPMENT

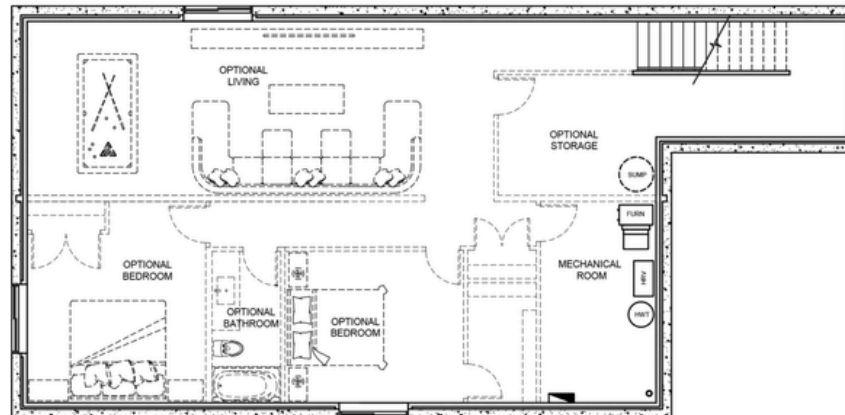

Disclaimer:  
 The above drawing is a graphical representation of the unit to be built. Site conditions may dictate changes or substitutions that have to be made and are not reflected on these drawings. Pacesetter Homes reserves the right to make such changes or substitutions as they see fit. Do not scale drawings; confirm dimensions on site.